



RS-POWER100A POWER SUPPLY

**Please carefully read the user manual.
Do not use your device without reading.**

Dear Customer,

First of all, we would like to thank you for choosing our REISS AUDIO branded device, which is the pioneer of quality.

In order for your device, which has been produced in modern facilities and has undergone rigorous quality control, to offer you the best efficiency,

Please read this entire manual carefully before using your device and keep it as a reference.

RULES TO BE FOLLOWED IN MAINTENANCE, REPAIR AND USE

ONLY AUTHORIZED TECHNICAL PERSONS CAN OPEN THE BACK COVER.
THE WARRANTY OF THE DEVICE IS APPLICABLE TO DEVICES WITHOUT OPEN BACK COVER.
TO AVOID FIRE HAZARD AND DANGEROUS SHOCK, DO NOT EXPOSE THE APPLIANCE TO MOISTURE OR RAIN.
DO NOT WIPE WITH A DAMP CLOTH WHILE THE DEVICE IS WORKING.

Wipe the device with a soft cloth.

Do not wipe the device with alcohol, gasoline or chemical cleaning agents.

MATTERS TO BE CONSIDERED DURING HANDLING AND SHIPPING

The device must be transported in its original packaging.
It should not be dropped, it should be kept away from water and excessively humid environment.
SITUATIONS THAT MAY BE HARMFUL TO HUMAN AND ENVIRONMENTAL HEALTH DURING USE
RISK OF ELECTRIC SHOCK INSIDE THE DEVICE, WHICH MAY BE DANGEROUS TO PEOPLE
'DANGEROUS VOLTAGE MAY BE AVAILABLE.
NEVER OPEN THE BACK COVER. OTHERWISE, THIS SITUATION CAN BE DANGEROUS TO PEOPLE AND
MAY CAUSE SERIOUS PROBLEMS IN THE OPERATION OF THE DEVICE

MAINTENANCE, REPAIR AND USAGE RULES

Only authorized technical personnel are allowed to open the rear cover.

The warranty is valid only for devices whose rear cover has not been opened.

To prevent fire hazards and dangerous electric shocks, do not expose the device to moisture or rain.

Do not wipe the device with a damp cloth while it is operating.

Maintenance

Clean the device with a soft cloth.

Do not use alcohol, gasoline, or chemical cleaning agents to clean the device.

PRECAUTIONS DURING TRANSPORTATION AND HANDLING

The device must be transported in its original packaging.

Do not drop it and keep it away from water and excessively humid environments.

SITUATIONS THAT MAY POSE A RISK TO HUMAN AND ENVIRONMENTAL HEALTH DURING USE

There may be dangerous voltage inside the device that can pose a risk of electric shock.

Do not open the rear cover under any circumstances. Otherwise, it may be dangerous for users and may cause serious operational issues.

USAGE ERRORS

Do not place the device on hot surfaces.

Unplug the device before cleaning.

Do not use the device if the cable or device is damaged.

Protect the device and cables from water and moisture

TECHNICAL FEATURES

The POWER 100A operates on AC power to supply devices requiring 10–16V DC output.

It converts standard 110–130V AC household power into an adjustable 10–16V DC output and delivers up to 100A continuous current.

The POWER 100A converts standard 220–240V AC input into an adjustable 10–16V DC output with up to 100A continuous current capacity.

Designed for versatile use, the POWER 100A is suitable for applications such as retail audio displays, show vehicles, and test bench operations.

Key Features:

Adjustable regulated output voltage: 10–16V DC

Continuous output current: up to 100A

Built-in cooling fans

Thermal overload protection

Current overload protection

Combo output terminals (binding post & banana plug compatible)

Pulse charging technology to reduce battery sulfation

Remote-mount LCD voltage display

Parallel connection support: up to 4 units (max. 400A total output)

IMPORTANT SAFETY INSTRUCTIONS

This manual contains important safety and operating instructions for the POWER 100A. To reduce the risk of fire, electric shock, and injury to person or equipment; carefully read the following before you use the power supply. Please read all cautionary markings on both the POWER 100A and on the product that you will connect to the power supply.

WARNINGS

This product is not recommended for outdoor use.
Do not expose the power supply to excessive moisture.
This product is not intended to be used as a stand-alone battery charger. It is designed for the purpose of providing supplemental power when a DC power generator isn't available. Do not connect the POWER 100A to a battery that is deeply discharged. The initial high level of current draw will force the power supply into current limit mode for prolonged periods. This type of use is harmful to the power supply.
When used as a supplemental power supply, the POWER 100A will not damage connected batteries. When a connected battery reaches a fully charged state, the POWER 100A will decrease its output current to a safe level gradually.
Make sure the power supply is securely mounted to avoid injury or damage to the unit.
The power supply should be operated only from a standard AC outlet that provides 120V AC/60Hz (220V AC/50Hz for POWER 100A), as indicated on the label.
Do not overload AC power outlets to avoid danger of electric shock and fire. A minimum current of 20A will be required.
Avoid using extension cords.
The power plug is polarized for safety. Do not defeat the ground feature.
Do not block or cover the power supply's cooling fan openings to avoid overheating.
Unplug the power supply during lightning storms to avoid power surge damage.
If your unit should require service or new parts, contact the manufacturer. Do not attempt to service the unit.

CONNECTIONS

CAUTION: Make all connections before you connect the power supply to AC power.

**Turn off the device requiring power.
Set the POWER 100A power switch to off.**

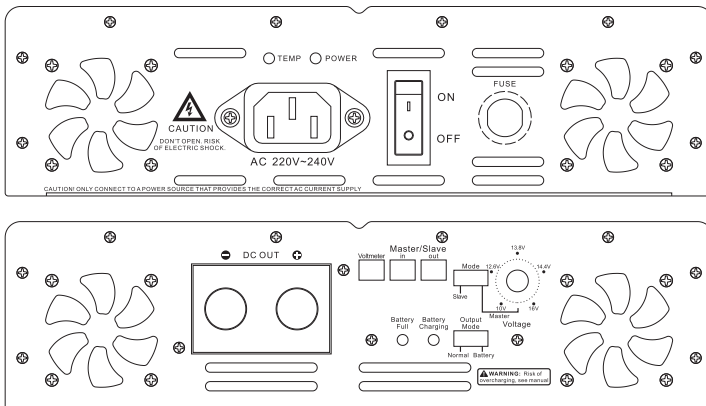

Parallel Connection

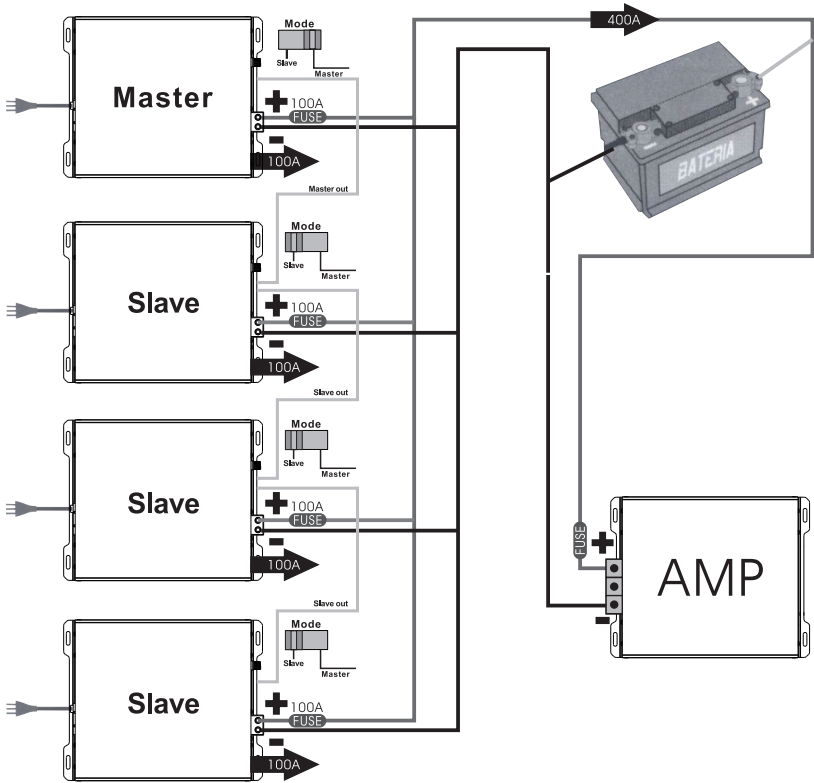

Technical Specifications

Input Voltage: 220V

Input Frequency: 50Hz

Adjustable Output: 10V–16V

Efficiency: 85%

Overload Protection: 10A / 250V Fuse

Output Ripple: 150mV RMS

Protection Temperature: 75°C

Cooling Fan: 4 pcs (40×40×10 mm)

Input Cable: UL 14AWG – 0 AWG

Power Switch: 10A / 250V AC

Dimensions: 262.4 × 67 × 247 mm

POSSIBLE ISSUES AND SOLUTIONS

Power supply not working! Check the connections.

Check the fuse or circuit breaker. If the fuse issue persists, check for a short circuit in the cable.

Check the protection fuses. Replace any blown fuses with new ones of the same rating.





RS-POWER100A POWER SUPPLY

**Please carefully read the user manual.
Do not use your device without reading.**

Dear Customer,

First of all, we would like to thank you for choosing our REISS AUDIO branded device, which is the pioneer of quality.

In order for your device, which has been produced in modern facilities and has undergone rigorous quality control, to offer you the best efficiency,

Please read this entire manual carefully before using your device and keep it as a reference.